



2019 Garrett Safety Cover Pricing

Effective July 16, 2019

- All pricing in this booklet is **suggested retail** pricing.
- Your “**multiplier**”, as an established pool professional, is **0.513**. This is based on a discount of 40% + 10% + 5%. Thus, a cover with a suggested retail of \$1,000.00 will cost you \$513.00, plus freight. We give you your discount up front so that you do not have to wait months for a volume rebate check or credit memo and are assured of your true final cost. If you purchase more than 75 safety covers in a calendar year, please contact us for any additional rebates that may be available. Your cover sales volume will be added to your liner sales volume to allow you to obtain larger liner volume discounts.

- **Pre-Payment Discounts**

- Pay-with-Order: If you pay at the time of order using check, cash, or direct debit to your checking account, we will discount your order by an additional 5%. If you pay for your order by Credit Card (VISA or MasterCard), your pre-payment discount is 3%. In order to qualify for this Pay-with-Order discount, we must have your payment before the day that your cover begins production.

- **Terms to Accounts with Established Credit**

- 2% - 10 days / net 30 days. Accounts unpaid after 30 days will be charged 1½ % interest per month, and your credit privileges may be jeopardized.

- **Deposits:** We reserve the right to require a 50% deposit before production, and custom covers can not be cancelled after production has begun.

- **Shipments:** FOB Fallsington, PA.

- **Returns:** Prior authorization is required before returns can be accepted and all freight must be prepaid. Custom covers are not returnable. Please see page 14 to send us a cover for repair or page 17 to send an old cover for use as a template for a new cover.

-
- ✓ **For custom covers**, this price book is intended as a guide only, to give you a good idea of how much a cover will cost. We will fax you a firm quote for your approval when we receive all the information on the custom cover. You must sign and return this form to us, unless other ordering arrangements have been made. We do this to assure that any possible complexities of the cover have been properly addressed.

- ✓ If there is any unusual feature or obstruction, please e-mail us photographs so that we can better visualize it and make the cover to fit properly. Our e-mail address is:

info@garrettliners.com

What Makes a Garrett Cover Your Best Choice

- All Garrett Safety Covers are fabricated using a **DOUBLE LAYER** of webbing throughout the cover for maximum strength and cover longevity. We use a full layer of webbing on both the top and entire bottom of the cover material to “sandwich in” the whole cover, not just the perimeter and a few feet in from the edge.
- Our stainless steel springs are “bent” at both ends to provide a lower profile and allow the cover to remain flush with the deck.
- We provide built in D-Rings on all our springs, as well as providing buckles, so you can decide which strap attachment method works best for you.
- Our Suggested Retail prices are generally lower than our competitors, so you can close more sales to homeowners.
- Our up-front discounts are generally more generous, too, so you can earn more profit per job.
- We sell direct to legitimate pool professionals.
- We do NOT sell to internet or Big Box sellers, so you will NEVER have that unfair competition from Garrett Covers.
- We have the brochures, samples, and other sales tools you need. Just ask us about what would work best for you.

Cover Specifications and Material Choices

- Cover pricing includes:
 - Stainless steel springs. Integral D-rings are included on the springs, and stainless steel buckles are attached to the straps. This allows you to choose your preferred means of securing the spring to the strap.
 - Vinyl spring covers to help protect the deck.
 - Brass anchors, threaded, with slot and hex head.
 - Tamping tool for anchor installation.
 - Installation tool – 30” long.
 - Mesh storage bag, with handles for carrying.
 - Installation instructions, warranty, and safety information.
 - Solid covers are priced with a center drain strip standard. You may delete the drain strip and replace it with an automatic cover pump at the additional charge shown.
- All Garrett Safety Covers are fabricated using a full layer of webbing on both the top and entire bottom of the cover material – length, width and perimeter. This “sandwiches in” the fabric for maximum strength and cover longevity.
- Spacing of straps
 - Nominal 5' spacing will range between 4' and 6'.
 - Nominal 3' spacing will range between 2' and 4'.
- Garrett Safety Covers conform to ASTM 1346-91, when properly ordered, installed, and maintained.
- Overlap
 - Most rectangles for pools up to 1,200 square feet have a 12" overlap (i.e., cover size is 2' greater than pool size). Over 1,200 square feet, the overlap is generally 15" to 18".
 - Form fit covers and the curved ends of ovals have a 15" to 18" overlap.
- A variety of cover fabrics is available. Please see the back cover for details.
Mesh ♦ UltraMesh ♦ Commercial grade mesh ♦ UltraSolid



QuickShip Covers

Garrett proudly continues to offer our **QUICKSHIP** program. On the items shown, your cover will be ready for shipment or pickup within **THREE DAYS**. We have pre-engineered these popular sizes so we can get them to you **QUICK**.

Unlike most of our competitors, you may choose **ANY COLOR** at the same low price.

All spacing is approximately 5' x 5', and the overlap is 12" on all sides. Be sure to check your coping size to ensure that the overlap will completely cover it.

On QuickShip covers, some minor variations in pool size can be accommodated You can use one of them on a pool if:

- The width and/or length is no more than 3" smaller than shown, provided you have at least 36" of deck.
- The width and/or length is no more than 3" larger than shown, provided you have at least 30" of deck, and your coping is no more than 9" wide.

Some variations in step size can be accommodated, provided the pool itself is exactly the width and length shown. The side-to-side measurement of the step can be up to 12" smaller than shown, and the front-to-back measurement of the step can be up to 6" smaller than shown. Be sure you have enough deck. Please contact us if you have any questions about whether a QuickShip cover will fit a particular pool.

The QuickShip Grecians have 6' corner panels and 8' panels across each end.

For **LEFT** or **RIGHT** steps, use the drawings to determine position, as some manufacturers look at them the opposite way.

The pricing for **ULTRASOLID** covers is with a **CENTER DRAIN STRIP**. If you wish, you can delete the drain strip and add a pump at an additional retail cost of \$211⁰⁰.

You may substitute for the standard anchors and/or springs as shown on page 9, at the upcharge listed. However, the cover itself can not be modified (i.e. cutouts, etc.) in any way.

To the item number shown below, please add the following suffixes to denote the material:

	UltraSolid			
	Mesh	w/Drain Strip	w/Pump add \$204.85	UltraMesh
Green	-01	-11	-21	-31
Blue	-02	-12	-22	-32
Tan	-03	-13	-23	-33
Gray	-04	-14	-24	-34
Black	-05	-	-	-

For example, a 16'x32' pool size rectangle w/4'x8' center steps in tan mesh would be ordered as a 110-03.

QuickShip covers can not be used on pools of other configurations or sizes, or the warranty is voided. The safety function of the cover may be compromised.

QuickShip Covers



Rectangles - No Steps				Retail Price		
Pool Size	Cover Size	# of Anchors	Item #	[-0x] Mesh	[-1x or -2x] UltraSolid	[-3x] UltraMesh
12x24	14x26	20	100	\$930	\$1,170	\$1,170
14x28	16x30	22	101	\$1,088	\$1,377	\$1,377
16x32	18x34	24	102	\$1,224	\$1,602	\$1,602
16x36	18x38	26	103	\$1,348	\$1,759	\$1,759
18x36	20x38	28	104	\$1,388	\$1,884	\$1,884
18x40	20x42	28	105	\$1,551	\$2,060	\$2,060
20x40	22x42	28	106	\$1,579	\$2,115	\$2,115



Rectangles – with 4' x 8' Center Steps				Retail Price		
Pool Size	Cover Size	# of Anchors	Item #	[-0x] Mesh	[-1x or -2x] UltraSolid	[-3x] UltraMesh
16x32	18x34	28	110	\$1,343	\$1,753	\$1,753
16x36	18x38	30	111	\$1,470	\$1,913	\$1,913
18x36	20x38	30	112	\$1,541	\$2,038	\$2,038
20x40	22x42	30	113	\$1,711	\$2,268	\$2,268

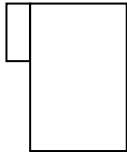

Rectangles - with Flush 4' x 8' Left Side Steps				Retail Price		
Pool Size	Cover Size	# of Anchors	Item #	[-0x] Mesh	[-1x or -2x] UltraSolid	[-3x] UltraMesh
16x32	18x34	26	120	\$1,343	\$1,753	\$1,753
16x36	18x38	28	121	\$1,470	\$1,913	\$1,913
18x36	20x38	30	122	\$1,541	\$2,038	\$2,038
20x40	22x42	30	123	\$1,711	\$2,268	\$2,268

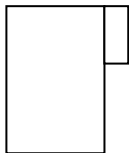

Rectangles - with Flush 4' x 8' Right Side Steps				Retail Price		
Pool Size	Cover Size	# of Anchors	Item #	[-0x] Mesh	[-1x or -2x] UltraSolid	[-3x] UltraMesh
16x32	18x34	26	125	\$1,343	\$1,753	\$1,753
16x36	18x38	28	126	\$1,470	\$1,913	\$1,913
18x36	20x38	30	127	\$1,541	\$2,038	\$2,038
20x40	22x42	30	128	\$1,711	\$2,268	\$2,268

All QuickShip covers are made with approximately 5' x 5' strap spacing, and the overlap is 12" on all sides.

For LEFT or RIGHT steps, use the drawings to determine this, as some manufacturers look at them the opposite way.

The pricing for ULTRASOLID covers is with a CENTER DRAIN STRIP. If you wish, you can delete the drain strip and add a pump at an additional retail cost of \$211⁰⁰.



QuickShip Covers

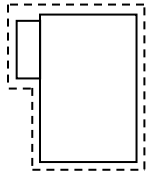

Rectangles - with 1' Offset 4' x 8' Left Side Steps				Retail Price		
Pool Size	Cover Size	# of Anchors	Item #	[-0x] Mesh	[-1x or -2x] UltraSolid	[-3x] UltraMesh
16x32	18x34	26	130	\$1,343	\$1,753	\$1,753
16x36	18x38	26	131	\$1,470	\$1,913	\$1,913
18x36	20x38	28	132	\$1,541	\$2,038	\$2,038
20x40	22x42	30	133	\$1,711	\$2,268	\$2,268

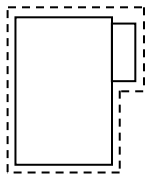

Rectangles - with 1' Offset 4' x 8' Right Side Steps				Retail Price		
Pool Size	Cover Size	# of Anchors	Item #	[-0x] Mesh	[-1x or -2x] UltraSolid	[-3x] UltraMesh
16x32	18x34	26	135	\$1,343	\$1,753	\$1,753
16x36	18x38	26	136	\$1,470	\$1,913	\$1,913
18x36	20x38	28	137	\$1,541	\$2,038	\$2,038
20x40	22x42	30	138	\$1,711	\$2,268	\$2,268

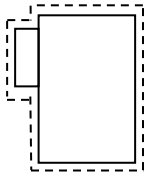

Rectangles - with 2' Offset 4' x 8' Left Side Steps				Retail Price		
Pool Size	Cover Size	# of Anchors	Item #	[-0x] Mesh	[-1x or -2x] UltraSolid	[-3x] UltraMesh
16x32	18x34	26	140	\$1,343	\$1,753	\$1,753
16x36	18x38	28	141	\$1,470	\$1,913	\$1,913
18x36	20x38	30	142	\$1,541	\$2,038	\$2,038
20x40	22x42	32	143	\$1,711	\$2,268	\$2,268

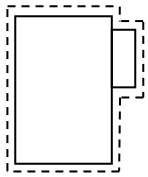

Rectangles - with 2' Offset 4' x 8' Right Side Steps				Retail Price		
Pool Size	Cover Size	# of Anchors	Item #	[-0x] Mesh	[-1x or -2x] UltraSolid	[-3x] UltraMesh
16x32	18x34	26	145	\$1,343	\$1,753	\$1,753
16x36	18x38	28	146	\$1,470	\$1,913	\$1,913
18x36	20x38	30	147	\$1,541	\$2,038	\$2,038
20x40	22x42	32	148	\$1,711	\$2,268	\$2,268

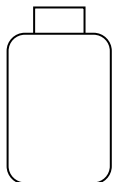

Rectangles - with 4' Radius Corners 4' x 8' Center Steps				Retail Price		
Pool Size	Cover Size	# of Anchors	Item #	[-0x] Mesh	[-1x or -2x] UltraSolid	[-3x] UltraMesh
16x32	18x34	34	150	\$1,463	\$1,872	\$1,872
16x36	18x38	36	151	\$1,588	\$2,036	\$2,036
18x36	20x38	38	152	\$1,658	\$2,157	\$2,157
20x40	22x42	38	153	\$1,828	\$2,391	\$2,391

QuickShip Covers

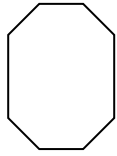

Grecians - with No Steps				Retail Price		
Pool Size	Cover Size	# of Anchors	Item #	[-0x] Mesh	[-1x or -2x] UltraSolid	[-3x] UltraMesh
16 ⁶ x32 ⁶	18 ⁶ x34 ⁶	26	160	\$1,452	\$1,836	\$1,836
16 ⁶ x35 ⁶	18 ⁶ x37 ⁶	28	161	\$1,546	\$1,956	\$1,956

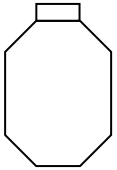

Grecians – with 4' x 8' Center Steps				Retail Price		
Pool Size	Cover Size	# of Anchors	Item #	[-0x] Mesh	[-1x or -2x] UltraSolid	[-3x] UltraMesh
16 ⁶ x32 ⁶	18 ⁶ x34 ⁶	28	170	\$1,574	\$1,988	\$1,988
16 ⁶ x35 ⁶	18 ⁶ x37 ⁶	30	171	\$1,666	\$2,108	\$2,108

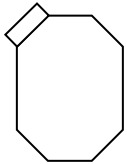

Grecians - with 4' x 6' Left Corner Steps				Retail Price		
Pool Size	Cover Size	# of Anchors	Item #	[-0x] Mesh	[-1x or -2x] UltraSolid	[-3x] UltraMesh
16 ⁶ x32 ⁶	18 ⁶ x34 ⁶	30	180	\$1,574	\$1,988	\$1,988
16 ⁶ x35 ⁶	18 ⁶ x37 ⁶	32	181	\$1,666	\$2,108	\$2,108

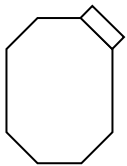

Grecians - with 4' x 6' Right Corner Steps				Retail Price		
Pool Size	Cover Size	# of Anchors	Item #	[-0x] Mesh	[-1x or -2x] UltraSolid	[-3x] UltraMesh
16 ⁶ x32 ⁶	18 ⁶ x34 ⁶	30	185	\$1,574	\$1,988	\$1,988
16 ⁶ x35 ⁶	18 ⁶ x37 ⁶	32	186	\$1,666	\$2,108	\$2,108

All QuickShip covers are made with approximately 5' x 5' strap spacing, and the overlap is 12" on all sides.

The Grecians shown have 6' corner panels and 8' panels across each end.

For LEFT or RIGHT steps, use the drawings to determine this, as some manufacturers look at them the opposite way.

The pricing for ULTRASOLID covers is with a CENTER DRAIN STRIP. If you wish, you can delete the drain strip and add a pump at an additional retail cost of \$211⁰⁰.



Custom Safety Cover Retail Prices

Effective July 16, 2019

Retail Pricing per Square Foot of Cover Size

Square Footage of Cover		Mesh Green, Blue, Black, Tan, or Gray			UltraSolid / UltraMesh Green, Blue, Tan or Gray				
		Rectangle Based Pricing		Form Fit	Rectangle Based Pricing		Form Fit		
From	To	5' Spacing	3' Spacing	3' Spacing	5' Spacing	3' Spacing	3' Spacing		
1	199	\$3.59	\$4.16	\$5.34		\$4.36	\$4.90	\$6.11	
200	299	\$2.96	\$3.49	\$4.54		\$3.64	\$4.19	\$5.41	
300	399	\$2.84	\$3.38	\$3.84		\$3.46	\$4.02	\$4.67	
400	499	\$2.46	\$3.02	\$3.47		\$3.09	\$3.63	\$4.24	
500	599	\$2.29	\$2.84	\$3.27		\$2.86	\$3.40	\$3.91	
600	699	\$2.17	\$2.72	\$3.16		\$2.72	\$3.27	\$3.79	
700	799	\$2.07	\$2.61	\$3.01		\$2.58	\$3.13	\$3.61	
800	899	\$1.98	\$2.51	\$2.97		\$2.46	\$3.02	\$3.51	
900	999	\$1.90	\$2.43	\$2.89		\$2.40	\$2.96	\$3.46	
1,000	1,099	\$1.85	\$2.39	\$2.87	Use 3' Spacing for: Solid Covers Over 1,000 Sq. ft. UltraMesh Covers Over 2,000 Sq. Ft.	\$2.35	\$2.90	\$3.41	
1,100	1,199	\$1.82	\$2.36	\$2.77		\$2.31	\$2.86	\$3.37	
1,200	1,299	\$1.80	\$2.34	\$2.74		\$2.29	\$2.84	\$3.33	
1,300	1,399	\$1.78	\$2.32	\$2.67		\$2.25	\$2.80	\$3.32	
1,400	1,499	\$1.75	\$2.29	\$2.65		\$2.22	\$2.78	\$3.30	
1,500	1,599	\$1.73	\$2.27	\$2.63		\$2.21	\$2.77	\$3.29	
1,600	1,699	\$1.71	\$2.25	\$2.63		\$2.20	\$2.76	\$3.28	
1,700	1,799	\$1.70	\$2.24	\$2.60		\$2.18	\$2.74	\$3.25	
1,800	1,899	\$1.65	\$2.18	\$2.58		\$2.16	\$2.71	\$3.23	
1,900	1,999	\$1.64	\$2.17	\$2.55		\$2.14	\$2.68	\$3.20	
2,000	3,999	Use 3' Spacing	\$2.39	\$2.81			\$2.95	UltraMesh Covers Only	\$3.52
4,000	5,999		\$2.60	\$3.06			\$3.22		\$3.84
6,000 and Over			\$2.71	\$3.19		\$3.35	\$4.00		
					Solid Covers Not Recommended for Covers Over 2,000 Sq. Ft.				

All prices are subject to change without notice.

- For Commercial Grade Mesh (Black), add 20% to Mesh Pricing.
- Center drain strip is standard on UltraSolid covers. Drain strip may be deleted and replaced with an automatic cover pump at an extra charge of \$211.00
- For special 18" x 18" strap spacing, add 30% to the square foot pricing of 3' spacing.

- To calculate Cover Size, please see pages 12 and 13 for details on various pool shapes.

- These prices are based on:

⇒ Rectangle

- Up to 1200 square feet, add 2' to length and width.
Example: 16' x 32' PS = 18' x 34' CS = 612 Ft²
- Over 1200 square feet, add 3' to length and width.
Example: 25' x 50' PS = 28' x 53' CS = 1,431 Ft²

⇒ Form Fit

- Add 3' to maximum length and width.

- Please refer to page 9 for additional customization charges that may be required for some covers.
- Please refer to page 10 and 11 for individual hardware and accessory prices.
- A common addition is stairs or love seats. Their cost is:

	Mesh	UltraSolid & UltraMesh
4' x 8' or Smaller	\$ 123	\$ 145
Larger size up to 5' x 10' (50 sq.ft)	\$ 145	\$ 181

Note: When calculating the square footage of the cover you do not need to round up partial feet measurements to the next higher even foot. Just use the exact dimensions. For example, a measurement of 18'-6" is priced as 18.5 feet for square footage calculations, not 19 feet.

Cover Customization Charges (Retail)

- | | <u>Mesh</u> | <u>UltraSolid / UltraMesh</u> |
|---|-------------------|-------------------------------|
| • Steps, love seats, etc. | | |
| 4' x 8' or smaller (Pool Size)..... | \$ 123 | \$ 145 |
| Larger step size up to 5' x 10' (Pool Size) [50 sq.ft.].... | \$ 145 | \$ 181 |
| Oversize steps/spas
greater than 50 sq. ft. (Pool Size)..... | \$ 2.90 / sq. ft. | \$ 3.54 / sq. ft. |
| • Lazy Ell..... | | \$ 109 |
| • Roman end | | \$ 77 per end |
| • Oval end | | \$ 67 per end |
| • Grecian and cut corner | | \$ 32 each |
| • Extended straps (longer than 24") | | \$ 3 ³⁶ per strap |
| • Regular cut out for hand rails, slides, etc..... | | \$ 95 each |
| • Y-straps | | \$ 25 each |
| • Perimeter padding | | |
| – Attached with Hook & Loop at the edge..... | | \$ 3 ⁸⁴ per foot |
| – Sewn on, outside edge of padding..... | | \$ 4 ⁶⁵ per foot |
| • Extra pads (first four, when required, are included)..... | | \$ 45 each |
| • Raised wall treatment (4' minimum) | | |
| – New cover (includes gap filler, clips on cover, and all cabling hardware) | | \$ 36 per foot |
| – Replacement cover (includes gap filler and clips on cover) | | \$ 28 per foot |
| • Up & Over | | |
| w/Flaps (up to 24" high each)..... | | \$ 88 per height |
| w/Pillows (up to 9" high each) | | \$ 220 per height |
| For total Up & Over heights greater than 24", please call for a quote. | | |
| • Specially designed cover to eliminate center strap..... | | \$ 66 |
| • Short deck installation (springs on cover) | | \$ 19 per strap |

Up charges for non-standard anchoring devices and springs:

- Substitute wood deck anchors for standard anchors \$ 4.48 ea.
- Substitute tubes w/anchors for standard anchors \$ 10.50 ea.
- Substitute lawn stakes for standard anchors..... \$ 1.42 ea.
- Substitute lawn spike for standard anchors..... \$ 14.31 ea
- Substitute short springs for standard springs..... N/C
- Substitute dual-coil springs for standard springs \$ 3.27 ea.
- Substitute super heavy duty springs for standard springs \$ 3.27 ea.

Deductions for replacement covers:

You may be able to re-use the existing anchors and, sometimes, springs from the old cover. Be sure to inspect them all carefully. You cannot reuse springs that are bent, broken, overstressed or otherwise deformed. If your anchors and/or springs are suitable for re-use, you may deduct:

- Springs w/covers \$ 4.50 ea.
- Anchors..... \$ 2.70 ea.
- You may also not need an installation tool, Allen wrench, or tap-in tool, and can deduct their costs. Be sure to let us know on your order.



Hardware and Accessory Prices (Retail)

These are retail prices, subject to normal dealer discounts.

Springs (All springs are stainless steel and come with vinyl spring cover and integral D-ring and bends at both ends to keep cover closer to the deck)

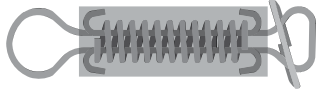

\$ 7.12

Standard 7½" length
For use with decks
3'-0" and wider

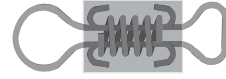

\$ 5.19

Short 5" length
For use with decks
2'-6" to 3'-0"

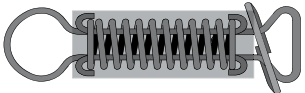

\$ 10.39

Super heavy duty, single coil
For use with decks
3'-0" and wider

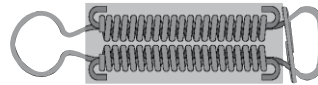

\$ 10.39

Dual-coil, low profile commercial
For use with decks
3'-0" and wider

Anchors

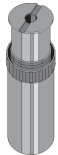

\$ 4.26

Brass - for concrete decks
Standard thread-type with hex
head and slot

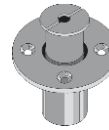

\$ 8.74

Brass - for wood decks
Complete with screws

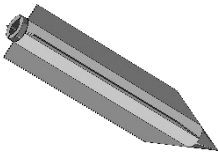

\$ 18.57

Lawn spike
For extra security in lawns

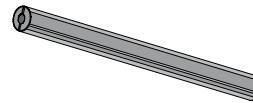

\$ 14.76

Aluminum tube with brass anchor
15" long

Lawn stakes [not to be used on more than 10% of cover and not on both ends of the same strap].....\$ 5.68

Installation hardware



\$ 2.96

Aluminum tamping tool



\$ 3.94

Allen wrench / Hex wrench
Tee handled



\$ 15.30

Installation tool
30" long



\$ 53.56

Stainless steel installation tool
30" long

Additional Hardware and Accessory Prices (Retail)

Wall hardware (for use in raised wall applications)

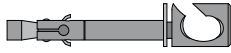

2" - \$ 13.67
4" - \$ 23.77

CableMate – Stainless Steel
Wall anchor and slotted cable latch.

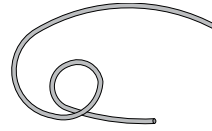

\$ 4.16
Per foot

Stainless steel cable
1/4" vinyl coated

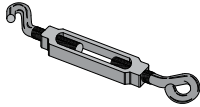

\$ 17.48

Turnbuckle –Stainless Steel w/Aluminum Body



\$ 8.21

U-clamp – Stainless Steel

Other hardware and accessories

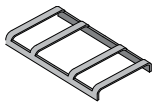

\$ 0.88

Stainless steel buckle

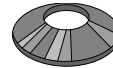

\$ 2.08

Brass flange/collar



\$ 1.09

D-ring



\$ 6.77

Snap Hook



\$ 21.32

Aboveground Deck Clamp

[**Can only be used on pools with
at least 2 feet of self-supporting
deck on all four sides.]**



\$ 272.95

Automatic cover pump

Replacement perimeter padding, w/Velcro type Hook or Loop sewn on

25 ft. x 24" width\$ 82.00

25 ft. x 36" width\$ 109.00

Replacement perimeter padding, for retrofit existing cover

25 ft. x 24" width\$ 75.00

25 ft. x 36" width\$ 99.00

Replacement spring covers, smoke color\$ 1.07

Special order and replacement gap filler pillowsCall for pricing

Mesh storage bag, with handles\$ 30.00

Extension straps, tipped at both ends 4' length\$ 8.21

6' length\$ 9.26

8' length\$ 10.40

Pricing of Various Shapes

The information below is intended to be a helpful guide in determining the square footage, and, therefore, the pricing of Garrett Safety Covers for various pool shapes. However, the exact pricing is only that contained on our quotation form that is faxed or e-mailed for your approval signature.

Unlike with some other manufacturers, when calculating the square footage of the cover you do not need to round up partial feet measurements to the next higher even foot. Just use the exact dimensions. For example, a measurement of 18'-6" is priced as 18.5 feet for square footage calculations, not 19 feet.

Rectangle

- Add 2' to width and length measurements if the cover is 1,200 sq. ft. or less. Add 3' if the cover is over 1,200 sq. ft.
- Multiply by appropriate "Rectangle" square foot pricing from page 4 or 5.

Example: 17' x 33' pool size = 19' x 35' cover size = 665 ft².

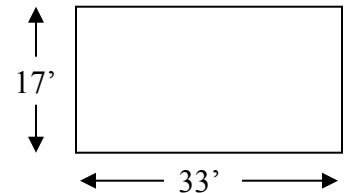

Grecian

- Add 2' to width and length measurements if the cover is 1,200 sq. ft. or less. Add 3' if the cover is over 1,200 sq. ft.
- Multiply by appropriate "Rectangle" square foot pricing from page 4 or 5.
- Add cost of four Grecian corners (Page 7).

Example: 16'-6" x 32'-6" pool size = 18'-6" x 34'-6" cover size = 638.25 ft².
Add price of four Grecian corners to calculated cost.

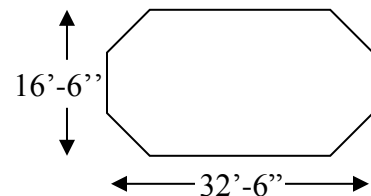

Oval

- Add 2' to width and 3' to length measurements if the cover is 1,200 sq. ft. or less. Add 3' to both length and width if the cover is over 1,200 sq. ft.
- Multiply by appropriate "Rectangle" square foot pricing from page 4 or 5.
- Add cost of two Oval ends (Page 7).

Example: 17' x 35' pool size = 19' x 38' cover size = 722 ft².
Add price of two Oval ends to calculated cost.

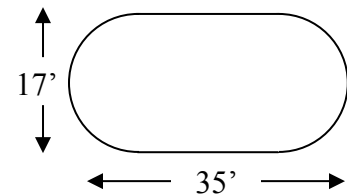

Roman Ends

- Add 2' to width and 3' to length measurements if the cover is 1,200 sq. ft. or less. Add 3' to both if the cover is over 1,200 sq. ft.
- Multiply by appropriate "Rectangle" square foot pricing from page 4 or 5.
- Add cost of Roman end(s) (Page 7).

Example: 16' x 38'-4" pool size = 18' x 41'-4" cover size = 744 ft².
Add price for Roman end(s) to calculated cost.

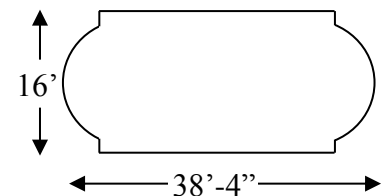

Pricing of Various Shapes (cont.)

True-L

- Determine the total square footage by adding the offset section to the main pool section.
- For main pool section, add 2' to width and length measurements if the cover is 1,200 sq. ft. or less. Add 3' if the cover is over 1,200 sq. ft.
- For offset section, add 2' to the dimension that is parallel to the longest pool wall. Add 3' if the cover is over 1,200 sq. ft. Do not add anything to the other dimension.
- Add these two sections together to get the total square footage, and multiply by appropriate "Rectangle" square foot pricing from page 4 or 5.

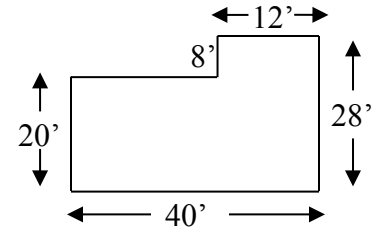

Example: Main section - 20' x 40' pool size = 22' x 42' cover size = 924 ft².
 Offset section - 8' x 12' pool size = 8' x 14' cover size = 112 ft².
 Total square footage = 924 ft² + 112 ft² = 1,036 ft².

Lazy-L

- Add the two segments of the length on the longest side, and then add 2' to this if the cover is 1,200 sq. ft. or less. Add 3' if the cover is over 1,200 sq. ft. This will generally result in a total length that is 2' less than most other manufacturers.
- Add 2' to the width of the pool if the cover is 1,200 sq. ft. or less. Add 3' if the cover is over 1,200 sq. ft.
- Multiply this width x length to get the total square footage.
- Multiply by appropriate "Rectangle" square foot pricing from page 4 or 5.
- Add Lazy-Ell charge (Page 7).

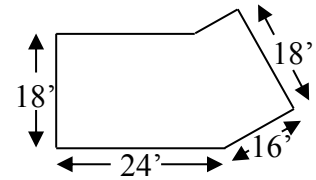

Example: 18' x 40' (24' + 16') pool size = 20' x 42' cover size = 840 ft².
 Add Lazy-Ell charge to calculated cost.

Free-Forms (Kidneys, Figure 8's, Mountain Lakes, etc.)

- Create a rectangular "box" that will include the pool and all extensions. The maximum width and maximum length will usually give you a close approximation.
- Add 3' to the width and length measurements of this "box".
- Multiply by appropriate "Form Fit" square foot pricing from page 4 or 5.

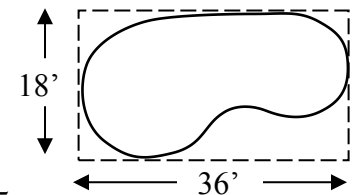

Example: 18' x 36' pool size = 21' x 39' cover size = 819 ft².



Safety Cover Repairs Policies

Effective July 16, 2019

- Listed repair prices are **retail** prices, and normal dealer discounts apply.
- These prices are intended to serve as a guide only. Actual prices may vary, based upon our inspection and evaluation of the cover.
- After July 16, our shop becomes very busy making new covers, and we cannot assure you that we can repair an old cover until November. We offer “Pre-Season” pricing on covers returned by July 1, and whose repair is authorized by July 16. After July 16, if we are able to schedule your repair before October 31, we would have to do it on an overtime basis and charge accordingly at 150% of the “Pre-Season” price.
- There is a **minimum** retail charge of \$100 (pre-season) or \$150 (peak season) on all covers returned for repair, even if no further work is done. This charge will be waived for any repair work done that totals more than the minimum.
- **All covers submitted for repair will be automatically repaired and billed for work completed if the total cost of the repairs is \$400.00 retail or less.** If the repair charges are greater than \$400.00 retail, Garrett will provide you with a cover repair quote, which must be signed and returned to Garrett before any repair work is started.
- If you are dropping off or shipping us a cover for repair:
 - Fill out a Return Authorization Request Form, fax it to us, and we will fax back to you an RGA number, which must be clearly marked on the cover being returned.
 - Remove all springs and make sure the cover is clean and dry to avoid our charges for spring removal, and drying and cleaning of the cover.
 - Ship the cover to us freight prepaid.
- Please be aware the coloration and shade of the replaced or repaired sections may not match that of the rest of the cover.
- **Some covers, due to their age or condition, may not be repairable. In such cases, we reserve the right to decline to repair them. If a new cover is not ordered, the inspection charge still applies.**
- We do not warrant that a repaired non-Garrett cover will meet the safety requirements of ASTM Standard ES1246-91, as that is a function of the original design and manufacture of the cover.
- Dirty covers can cause damage to the machinery used to repair the cover. Please clean all covers before delivering them to Garrett. For any cover returned that is dirty, wet, and/or insect infested, a \$500.00 (retail) charge will be added to the cost of the repair.
- We repair covers made by most Safety Cover manufacturers.

Safety Cover Repairs

Retail Pricing Guidelines

Effective July 16, 2019



Examples of common repairs:

	Pre-Season November 1 - July 14	Peak Season July 16 – October 31
<u>Panel replacement:</u>		
Edge Panel	\$ 113.00	\$ 169.50
Interior Panel	\$ 136.00	\$ 204.00
<u>Panel repair:</u>		
Edge Panel	\$ 57.00	\$ 85.50
Interior Panel	\$ 69.00	\$ 103.50
<u>Strap repair / replacement:</u>	\$ 2.27 / foot	\$ 3.41 / foot
<u>Chafing strip replacement:</u>	\$ 5.67 each	\$ 8.51 each
<u>Add pads:</u>	\$ 85.00 each	\$ 127.50 each
<u>Add perimeter padding:</u>		
Hook and Loop Sewn On Cover Edge	\$ 4.27 / foot	\$ 6.41 / foot
Sewn on Outside Edge Only	\$ 5.36 / foot	\$ 8.04 / foot
<u>Add or remove drain strip:</u>	\$ 17.05 / foot	\$ 25.58 / foot
<u>Replace drain panel:</u> (non-Garrett covers only)	\$ 113.00 each	\$ 169.50 each
<u>Add Step:</u> (minimum cost)	\$ 340.00 each	\$ 510.00 each
<u>Add cutout:</u> (minimum cost)	\$ 171.00 each	\$ 256.50 each
<u>Springs not removed:</u>	\$ 300.00	\$ 450.00
<u>Dirty/Wet Cover:</u>	\$ 500.00	\$ 500.00
<u>Repairing a cover over 1,500 sq. ft.:</u>	\$ 300.00	\$ 450.00
<u>Inspection Fee</u> (see note on page 14)	\$ 100.00	\$ 150.00
<u>Template Disposal Fee</u>	\$ 46.00	\$ 46.00

Note: Panel replacement costs are for standard type panels with no special features or attachments.



The Protector

If you need to replace an existing cover that uses rubber tension straps, like those made by Anchor and others, Garrett now offers the Protector to meet your needs. The Protector is an all RF-welded cover of solid reinforced vinyl coated material.

All Protector covers made by Garrett:

- Come with new rubber tension straps for your existing anchors
- Are available in green or blue.
- Require an Automatic Pool Cover Pump to be safe and meet the Safety Standards. This is available from Garrett at an additional retail charge of \$272.95. Drain strips may not be used with a Protector cover.
- Do not include a storage bag. One can be purchased for \$30.00 (retail).

If you return a cover for us to measure as a template for your cover, there is a \$247.00 charge to match the grommets on the new cover to the existing cover.

Other additions for special treatments and special hardware are as shown on pages 9, 10, and 11.

Retail Pricing per Square Foot of Cover Size

Square Footage of Cover		Green or Blue	
		Rectangular	Form Fit
From	To		
1	399	\$ 3.16	\$ 3.34
400	599	\$ 2.52	\$ 2.68
600	799	\$ 2.47	\$ 2.65
800	999	\$ 2.35	\$ 2.46
1,000	1,199	\$ 2.32	\$ 2.40
1,200	1,999	\$ 2.21	\$ 2.35

All prices are subject to change without notice.

To be considered rectangular for pricing, the cover must have all square corners. Price cut corners, lazy-ells, and all other shapes as Form Fit. There is no additional charge for shape or stairs, as they are included in overall size calculation



Warranty

Garrett Safety Covers are warranted to the original consumer purchaser to be free of defects in workmanship when properly ordered, installed, used, and maintained on a limited, pro-rated basis, for the following periods:

Mesh, UltraMesh, and Commercial Mesh -----	15 years
UltraSolid -----	10 years

Please see the warranty for details and exclusions.

For safety covers with an automatic cover pump, please note that the pump is warranted by the pump manufacturer.

Replacement Covers

Eventually, even the very best safety cover will need replacement. When this happens, and a replacement cover is needed:

- ⇒ If the original cover was a Garrett Safety Cover, you can identify the cover by supplying us with the original Serial Number.
- ⇒ If it was made by another manufacturer, you can either send us the old cover to use as a template, or provide us with precise “A-B” dimensions of both the pool perimeter and the existing anchors.
 - When sending us the old cover as a template, remember to remove all the old springs. Submit a return authorization request, informing us that the cover being delivered is a template, not a cover for repair. We will send you a numbered Return Authorization form. Be sure to include the return authorization number with the cover when you return it. **Please be aware that the returned cover may have either shrunk or stretched from its original dimensions. The new cover will be made just like the one you send to us.** Be sure to check the drawing that we return to you with your quote for consistency with the size of your pool. A \$46 (retail) disposal fee will be charged on all templates. If your customer decides not to order the new cover and requests that the cover be returned, there is a required retail measuring fee of \$100 (pre-season) or \$150 (peak season).
 - When taking “A-B” dimensions, you must use the same A and B points for measuring the pool perimeter and the anchor locations. If there is any possibility of confusion, be sure to clearly identify which points are pool perimeter and which are anchors. For irregularly shaped covers, it is very helpful if you can identify at least one pair of anchors that are on opposite ends of the same strap.

Please note: no matter which method is used, we cannot guarantee 100% accuracy in matching straps to anchors. You should be prepared to accept a possible strap mismatch rate of up to 10%.



Garrett Covers now carries the CoverBlast® pool cover pump nozzle from J Plus Products, Inc. The CoverBlast® eliminates the garden hose from the pool.

It attaches easily to most pool cover pumps and will shoot water up to 25 feet away from the pool when connected to a 1800 GPH pool cover pump. It can remain attached to the pump when not in use and will not freeze during the winter months.

\$ 28.99 retail

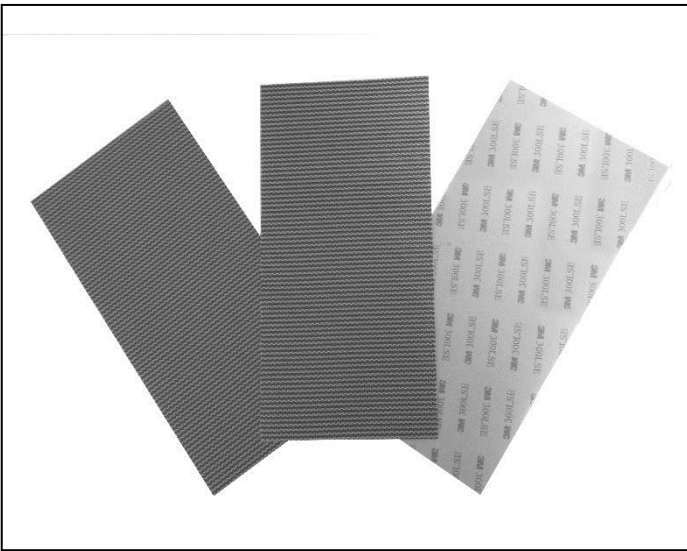

Sometimes, the unexpected happens, and you discover a hole in your Safety Cover.

For small repairs (holes less than 3" in size), Garrett offers a full line of Safety Cover Repair Patch Kits. Each kit includes three 4"x8" self-adhesive patches. There is a patch kit available for every style of Garrett Safety Cover. You can also use Garrett Patch Kits on most major safety cover manufacturer's covers (there may be some color variation).

\$ 35.00 retail

...and remember to use



For all of your Vinyl Swimming Pool Liner needs. Let us put our 50+ years of fabricating experience to work for you. Visit our website today at:

www.GarrettLiners.com